

Accessories for Magnetic Stirrers



Heating bath¹		
1l	PTFE coated	504-93100-00
2l	PTFE coated	504-92100-00
4l	PTFE coated	504-91100-00



Heating bath for oil¹		
1l	max. temperature 250 °C	504-93000-00
2l	max. temperature 250 °C	504-92000-00
4l	max. temperature 250 °C	504-91000-00



Concave block adapter¹		
For 1 l round-bottom flasks		504-94000-00



Magnetic stirring bars		
PTFE coated		
cylindrical 25, 40, 50 mm	1 piece each	509-56000-00
Cross shape 16.5 mm For 25–50 ml flask	Pack of 20	509-58500-00
Evaluation kit for round-bottom flask cross-shaped 10 and 16.5 mm, elliptical 25 mm, oval 40 and 50 mm	2 pieces each	509-58300-00
oval 15×6 mm for round-bottom flask 10 ml	Pack of 3	509-53000-00
oval 25×10 mm for round-bottom flask 25–50 ml	Pack of 3	509-54000-00
oval 30×10 mm for round-bottom flask 100–250 ml	Pack of 3	509-55000-00



Silicone protective cover		
Protects magnetic stirrers from splashing and dripping water		
For Hei-Connect		23-07-06-05-59
For Hei-PLATE Mix 20l		23-07-06-05-77
For Hei-PLATE Mix 'n' Heat models		23-07-06-05-76

¹ For magnetic stirrers with plate Ø 145 mm.
An adapter plate is available for models with Ø 135 mm.



Adapter plate	
For use of accessories for Ø 145 mm heating plate with Ø 135 mm models	
P/N 505-99000-01	

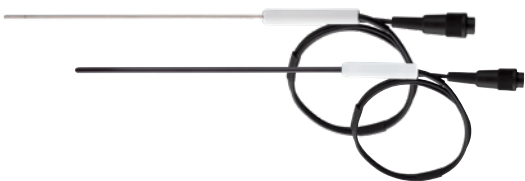

Pt 1000 temperature sensor	
For Hei-PLATE Mix 'n' Heat Core+	
V4A	509-67910-00
Glass-coated	509-67920-00



Pt 1000 clamping system	
With support rod and clamping device with cable routing	
P/N 509-63100-00	



Pt 1000 clamping system for large attachments (3–5 l)	
With support rod and clamping device with cable routing	
For Hei-Connect	509-63200-00
For Hei-Plate Mix'n'Heat models	509-63300-00

Hei-Con electronic contact thermometer	
For Hei-PLATE Mix 'n' Heat Core+	
V4A	509-88000-00
Glass-coated	509-88100-00



RS 232 cable	
9-pin, for Hei-Connect	
P/N 14-007-040-72	



Heating bath liquid	
Heating bath liquid (5 kg)	
up to 170 °C	515-31000-00
up to 220 °C	569-00600-00

Air instead of water.

The Findenser™ – the green alternative

More safety in the laboratory

The Findenser™ is a high performance condenser and replaces the need for water-cooled condensers in over 95 % of all common chemistry applications. The finned aluminum jacket provides excellent heat transfer.

Leading safety standards

No danger due to leakages and flooding in the laboratory – for unlimited continuous operation

Superior ease of use

Easy handling, no tubing – more space in the laboratory

Reduced cost of ownership

No water consumption – resource friendly and cost-effective

- Immediate use
- Absolutely flexible use – no water connection necessary
- Large cooling surface
- No running costs
- No performance difference compared to conventional reflux condensers



Aluminum cooling fins

Excellent thermal conductivity and chemical-resistant, anodized surface

Ground glass cones/sockets

The upper ground sleeve and lower ground core are available in different sizes

Patented design

Encapsulated thermofluid for maximum heat transfer

Easy fixing

With standard laboratory clamps or with the Findenser™ attachment kit

Prisma design

No rolling away due to flattened edges. Risk of damage is minimized



Findenser NS24 Cone	NS24 Socket	400 mm	505-81700-00
Findenser NS29 Cone	NS24 Socket	400 mm	505-81710-00
Findenser NS19 Cone	NS19 Socket	400 mm	505-81720-00
Findenser Mini NS24 Cone	NS24 Socket	275 mm	505-81800-00
Findenser Mini NS19 Cone	NS19 Socket	275 mm	505-81810-00
Findenser Mini NS14 Cone	NS14 Socket	275 mm	505-81820-00

Attachment kit:
2x retort clamp, 2x boss head, support rod 11-300-008-23

The Buyer's Guide provides answers to the most important questions on the advantages and disadvantages of a reflux cooler and what must be noted when purchasing.

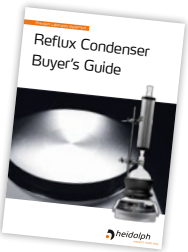

Heat-On Blocks

Safe, fast and efficient

Replace oil baths and heating mantles in your lab and reduce the risk of fire. Heat-On blocks are the safest, fastest and most efficient method for heating and stirring in round-bottom flasks from 10 ml to 5 l.

Leading Safety Standards

Increased occupational safety and fire protection: The elimination of oil baths prevents accidents, fires and contamination. The unique design prevents glass breakage and therefore minimizes the risk of cut injuries and leaking liquids. The high temperature accuracy offers leading safety standards for applications up to 260 °C.

Superior Ease of Use

The temperature can be measured conveniently and precisely, in the medium or directly on the reaction attachment. Oil is no longer necessary as a heat conductor, as the attachments enclose the flask with a precise fit. The cleaning effort is minimized. The PTFE coating offers the highest chemical resistance and corresponding use for many years.

Reduced Cost of Ownership

Thanks to the simplified handling, process times are minimized and the sample throughput is increased: 150 ml of water are brought to the boil in less than 11 minutes. In addition, the 66 % faster heating times compared to conventional oil baths save on energy costs.



Flask size	Liquid capacity	Hotplate temperature	Time to boiling point
10 ml	6 ml	300 °C	6.8 min
25 ml	15 ml	300 °C	8.0 min
50 ml	30 ml	300 °C	8.5 min
100 ml	60 ml	300 °C	8.8 min
150 ml	100 ml	300 °C	10.0 min
250 ml	150 ml	300 °C	10.8 min
500 ml	300 ml	300 °C	16.4 min
1000 ml	600 ml	300 °C	21.1 min
2000 ml	1200 ml	300 °C	35.1 min
3000 ml	1800 ml	300 °C	47.3 min
4000 ml	2400 ml	300 °C	51.0 min
5000 ml	3000 ml	300 °C	75.5 min

Heat-On Attachments



Heat-On blocks

Block with lateral cut-outs	100 ml	505-80066-00
Block	250 ml	505-80067-00
Block with lateral cut-outs	250 ml	505-80067- 01
Block	500 ml	505-80069-00
	1 l	505-80071-00
	2 l	505-80073-00
	3 l	505-80075-00
	4 l	505-80078-00
	5 l	505-80076-00

Heat-On attachments

Clamping system for 3–5 l attachments	509-63200-00
Retort clamp	505-81075-00
Boss head	570-31100-00

Attachment kit for flasks

Support rod for large attachments and holding device with cable routing, retort clamp, boss head for Hei-Connect	505-81400-00
for Hei-PLATE Mix 'n' Heat Core / Core+	509-63400-00

Multi-Well inserts and clamping system

Heat-On insert	10 ml	505-80061-00
	25 ml	505-80062-00
	50 ml	505-80063-00
	100 ml	505-80064-00
	150 ml	505-80065-00
Heat-On Multi-Well holder		505-80060-00
Heat-On safety lifting handles		505-80077-00

Safety covers

For Heat-On Multi-Well holder	505-80080-00
For Heat-On 200–300-ml Block	505-80081-00
For Heat-On 500 ml Block	505-80082-00
For Heat-On 1 l Block	505-80083-00

Heat-On Multi-Well packages

Package Heat-On Multi-Well Basic Includes 1 multi-well holder and 3 inserts (for 25-ml, 50-ml and 100-ml flasks)	505-81300-00
Package Heat-On Multi-Well Includes 1 multi-well clamping system and 6 inserts (for 2 × 25, 2 × 50 and 2 × 100 ml flasks)	505-81200-00

For magnetic stirrers with plate Ø 145 mm.
An adapter plate is available for models with Ø 135 mm.

Space-saving Working

With the StarFish workstation. Simply combine available round-bottom flasks and other vessels with the suitable StarFish attachments.

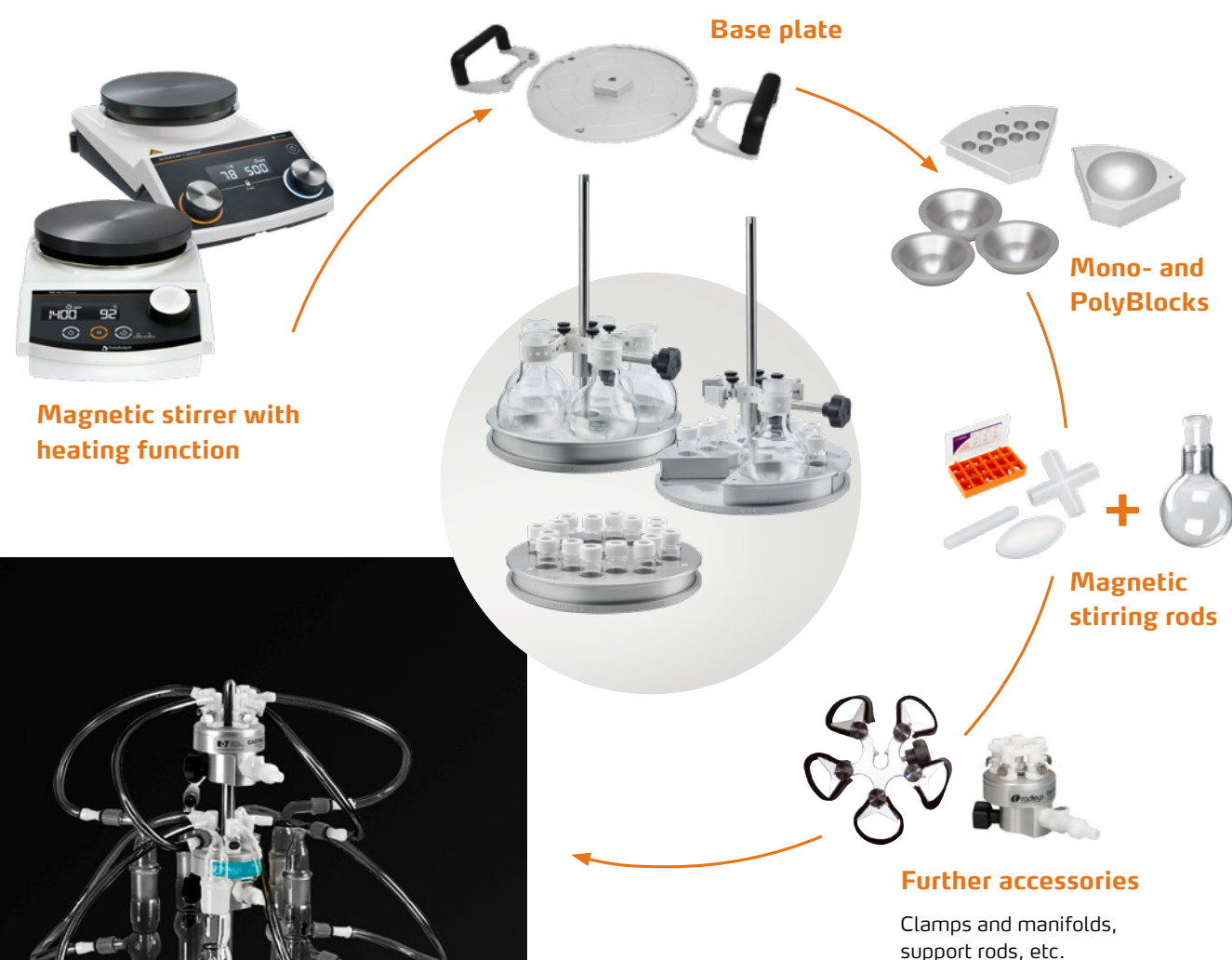

The setup of a StarFish workstation is finished

StarFish workstation are ideally suitable for Soxhlet applications.

StarFish Workstation

Process a large number of reactions in a space-saving and time-saving way

- Numerous attachments transform the magnetic stirrer into a multiple, efficiency-increasing reaction system for a maximum of 45 samples simultaneously
- Versatile all-rounder
- Countless possibilities: From simple heating and stirring tasks to syntheses through to concentrations and extractions with vacuum and inert gas
- No need to purchase new glass components. Simply work with the existing round-bottom flasks and combine them with the matching StarFish attachments
- Mono and PolyBlocks offer combination options for up to five individual PolyBlocks in different sizes or a MonoBlock with uniform insert sizes



Mono and PolyBlocks offer combination options for up to five individual PolyBlocks in different sizes or a MonoBlock with uniform insert sizes.

StarFish accessories – see page 46.



StarFish Accessories

 To the configuration overview
of StarFish workstation



Base plate

The baseplate fits exactly on the heating plate of the magnetic stirrer and ensures very good contact with the heated surface.

StarFish base plate	145 mm Ø	505-81000-00
StarFish safety handles	Pack of 2	505-81001-00

MonoBlocks

MonoBlocks consist of one block with several inserts of the same size and are ideal for applications with identical vessels.

MonoBlock for flasks	5 × 250 ml	505-80001-00
Flask insert	150 ml	505-80040-00
	100 ml	505-80041-00
	50 ml	505-80042-00
	25 ml	505-80043-00
	10 ml	505-80044-00
	5 ml	505-80045-00
MonoBlock for test tubes	16 × 25 mm Ø	505-80002-00
	16 × 24 mm Ø	505-80003-00
	40 × 16 mm Ø	505-80004-00
	40 × 12 mm Ø	505-80005-00
MonoBlock for cylindrical reagent vials	16 × 28 mm Ø	505-80006-00
	20 × 21 mm Ø	505-80007-00
	40 × 17 mm Ø	505-80008-00
	40 × 15 mm Ø	505-80009-00
	40 × 12 mm Ø	505-80010-00

PolyBlocks

PolyBlocks are made from narrow segments (five per baseplate), which can be combined suitably to match the vessel size; ideal for use of different vessel types and sizes.

PolyBlock for flasks	1 × 250 ml	505-80020-00
	3 × 25 ml	505-80021-00
	3 × 24 ml	505-80022-00
	9 × 16 ml	505-80023-00
	9 × 12 ml	505-80024-00
PolyBlock for reagent vials	3 × 28 ml	505-80025-00
	3 × 21 ml	505-80026-00
	7 × 17 ml	505-80027-00
	9 × 15 ml	505-80028-00
	9 × 12 ml	505-80029-00

For magnetic stirrers with plate Ø 145 mm.
An adapter plate is available for models with Ø 135 mm.



Universal 5-way clamp

The StarFish clamp enables different size glassware sets to be fixed and is optionally available with a silicone or Velcro® strap.

Each clamp is made up of five telescopic arms, which can be extended as required and can therefore be fixed securely around the vessel. Application example for the use of both clamps: The silicone strap holds the vessels securely, lift the samples with a handle if necessary, while the Velcro® strap enables the cooler to slip through.

5-way clamp with Velcro® strap	505-81010-00
5-way clamp with silicone strap	505-81020-00

Water manifold

Distributes water evenly from one output source to up to five condensers.

Two water manifolds are always used in the set-up. One to distribute the water and a second one to collect the water again. Either for further use or to remove it completely. Each of the five connections has a leakproof cut-off valve.

Water manifold with connections	505-81030-00
---------------------------------	--------------

Gas/vacuum manifold

Distributes inert gas or vacuum from an output source uniformly to five different stations or vessels. Regulating the gas or vacuum is not possible. Each of the five connections has a leakproof cut-off valve.

Gas / vacuum manifold with connections		505-81040-00
Replacement Velcro® pads for telescopic arms	200 mm (pack of 10)	505-81070-00
Replacement Velcro® straps	200 mm (pack of 5)	505-81080-00
Replacement spare silicone strips	200 mm (pack of 5)	505-81090-00
Support rod	650 mm	505-81050-00
Support rod, separable	650 mm	505-81060-00